

SOLAIRE

BY PALOMINO

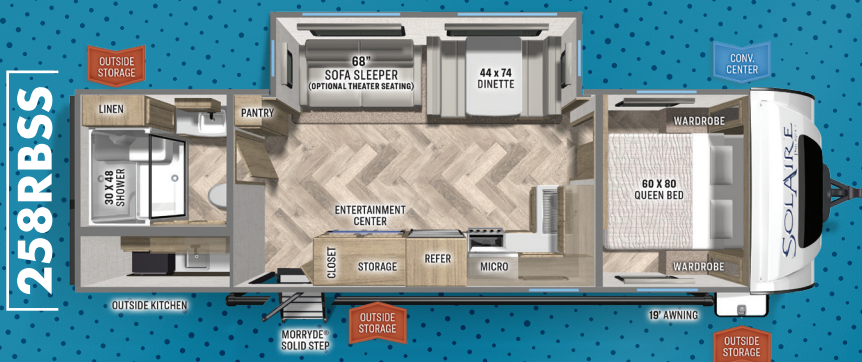
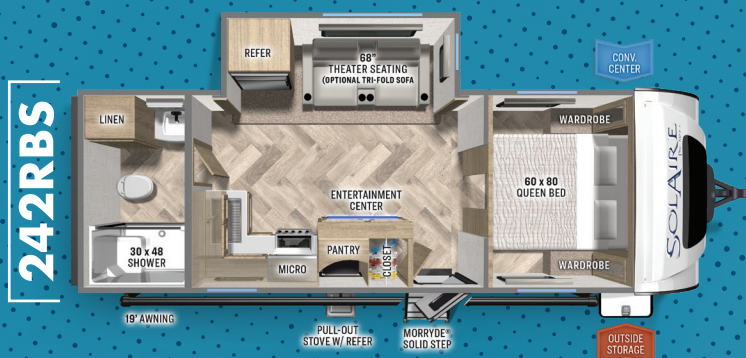
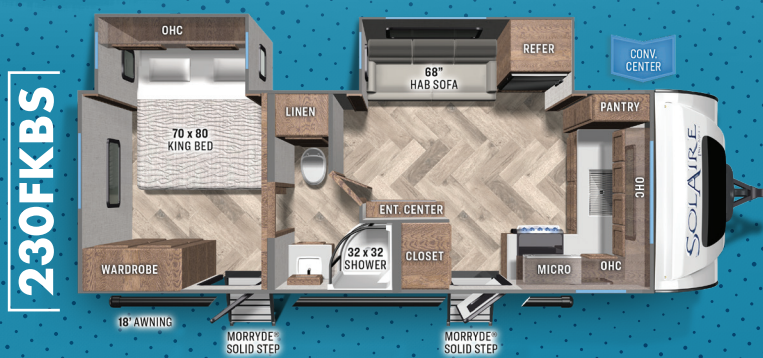

We Build with Superior Standards.

SolAire Ultra Life travel trailers are easy to tow, yet built to last with a sturdy aluminum framed superstructure for long lasting durability.

NON-BUNK MODELS

SPECS	208SS	230FKBS	242RBS	258RBSS	306RKTS
Length	24' 2"	26' 9"	27' 11"	32' 8"	36' 3"
Width	8'	8'	8'	8'	8'
Int. Height	6' 8"	6' 8"	6' 8"	6' 8"	6' 8"
Ext. Height	11' 1"	11' 1"	11' 1"	11' 1"	11' 1"
Awning	16'	18'	19'	19'	21'
Hitch	615	718	625	765	935
Axle	4170	5106	5025	5595	7170
UVW	4823	5862	5688	6398	8143
CCC	1492	1526	1577	1367	1792
Fresh Water	42	42	42	42	42
Gray Water	38	60	38	68	106
Black Water	30	30	38	30	38

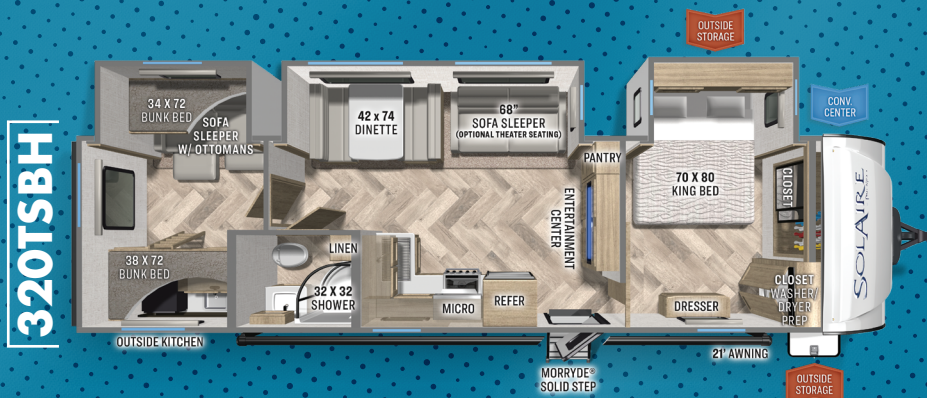
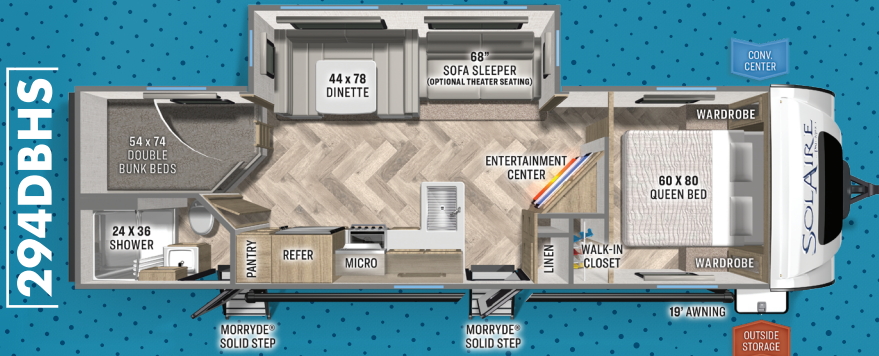
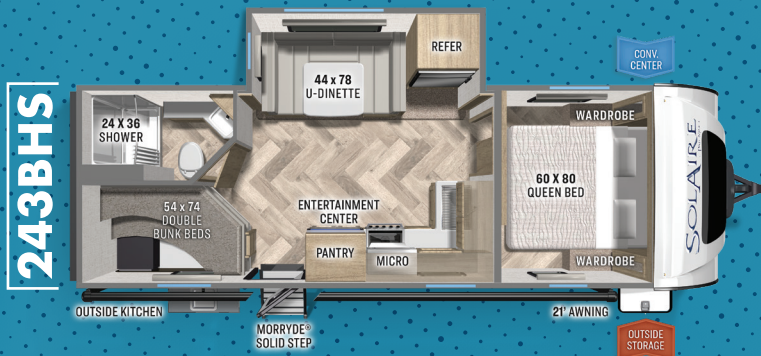

SolAire Ultra Lites are the result of superior design and modernization. Striving to meet all customer demands, this travel trailer provides a smooth ride with independent suspension axles, aluminum superstructure frame for light-weight towing, and barreled ceilings for a more spacious interior.

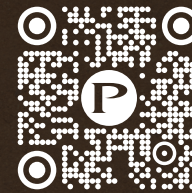

Scan with your Mobile Device

Virtual Tours, Photos, videos, follow Palomino on Social Media, and more!
www.palominorv.com

BUNK MODELS

SPECS	243BHS	294DBHS	315DQBH	320TSBH
Length	28' 11"	33' 6"	36' 4"	36' 3"
Width	8'	8'	8'	8'
Int. Height	6' 8"	6' 8"	6' 8"	6' 8"
Ext. Height	11' 1"	11' 1"	11' 1"	11' 1"
Awning	21'	19'	20'	21'
Hitch	570	675	838	1085
Axle	4925	5680	6170	6835
UVW	5533	6393	7046	7958
CCC	1587	1282	1862	1867
Fresh Water	42	42	42	42
Gray Water	60	60	106	98
Black Water	30	30	38	30

DEFINITIONS

GVWR (Gross Vehicle Weight Rating): is the maximum permissible weight of the unit when fully loaded. It includes all weights, inclusive of all fluids, cargo, optional equipment and accessories. For safety and product performance do NOT exceed the GVWR.

GAWR (Gross Axle Weight Rating): is the maximum permissible weight, including cargo, fluids, optional equipment and accessories that can be safely supported by a combination of all axles.

UVW (Unloaded Vehicle Weight): is the typical weight of the unit as manufactured at the factory. It includes all weight at the unit's axle(s) and tongue or pin and LP Gas. The UVW does not include cargo, fresh potable water, additional optional equipment or dealer installed accessories.

CCC (Cargo Carrying Capacity): is the amount of weight available for fresh potable water, cargo, additional optional equipment and accessories. CCC is equal to GVWR minus UVW. Available CCC should accommodate fresh potable water (8.3 lwt per gallon). Before filling the fresh water tank, empty the black and gray tanks to provide for more cargo capacity.

Each Forest River RV is weighed at the manufacturing facility prior to shipping. A label identifying the unloaded vehicle weight of the actual unit and the cargo carrying capacity is applied to every Forest River RV prior to leaving our facilities.

The load capacity of your unit is designated by weight, not by volume, so you cannot necessarily use all available space when loading your unit.

All information contained in this document is believed to be accurate at the time of publication. However, during the model year, it may be necessary to make revisions and Forest River, Inc., reserves the right to make all such changes without notice, including prices, colors, materials, equipment and specifications as well as the addition of new models and the discontinuance of models shown in this brochure. Therefore, please consult with your Forest River dealer and confirm the existence of any materials, design or specifications that are material to your purchase decision. © 2023 Palomino RV, a Division of Forest River, Inc., a Berkshire Hathaway Company. All Rights Reserved. 08/01 Palomino

1 Estimated Average based on standard build optional equipment

SOLLAIRE

BY PALOMINO

HYBRIDS

147 H



163 H



244 H

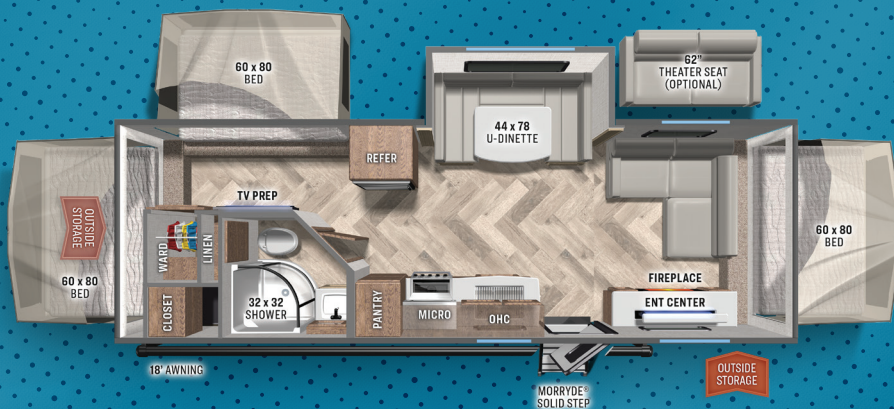

241 H

Coming Soon! Stay tuned for more information at www.palominorv.com



Our Hybrid expandable bed ends create a comfortable and spacious interior design for that home-like feel. They include many popular features to deliver the very best value to the market.

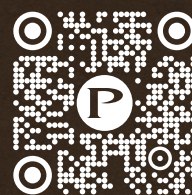

Scan with your Mobile Device

Virtual Tours, Photos, videos, follow Palomino on Social Media, and more!

www.palominorv.com

SPECS	147 H	163 H	244 H
Travel Length	19' 1"	20' 9"	29'
Open Length	23' 2"	24' 11"	32' 8"
Width	8'	8'	8'
Int. Height	6' 8"	6' 8"	6' 8"
Ext. Height	10' 1"	10' 1"	10' 1"
Awning	10'	10'	18'
Hitch	375	375	585
Axle	2995	3195	4660
UVW	3408	3608	5283
CCC	1067	1167	1302
Fresh Water	35	35	35
Gray Water	38	30	60
Black Water	30	30	30

DEFINITIONS

GVWR (Gross Vehicle Weight Rating): is the maximum permissible weight of the unit when fully loaded. It includes all weights, inclusive of all fluids, cargo, optional equipment and accessories. For safety and product performance do NOT exceed the GVWR.

GAWR (Gross Axle Weight Rating): is the maximum permissible weight, including cargo, fluids, optional equipment and accessories that can be safely supported by a combination of all axles.

UVW (Unloaded Vehicle Weight): is the typical weight of the unit as manufactured at the factory. It includes all weight at the unit's axle(s) and tongue or pin and LP Gas. The UVW does not include cargo, fresh potable water, additional optional equipment or dealer installed accessories.

CCC (Cargo Carrying Capacity): is the amount of weight available for fresh potable water, cargo, additional optional equipment and accessories. CCC is equal to GVWR minus UVW. Available CCC should accommodate fresh potable water (8.3 lwt per gallon). Before filling the fresh water tank, empty the black and gray tanks to provide for more cargo capacity.

Each Forest River RV is weighed at the manufacturing facility prior to shipping. A label identifying the unloaded vehicle weight of the actual unit and the cargo carrying capacity is applied to every Forest River RV prior to leaving our facilities.

The load capacity of your unit is designated by weight, not by volume, so you cannot necessarily use all available space when loading your unit.

All information contained in this document is believed to be accurate at the time of publication. However, during the model year, it may be necessary to make revisions and Forest River, Inc., reserves the right to make all such changes without notice, including prices, colors, materials, equipment and specifications as well as the addition of new models and the discontinuance of models shown in this brochure. Therefore, please consult with your Forest River dealer and confirm the existence of any materials, design or specifications that are material to your purchase decision. © 2023 Palomino RV, a Division of Forest River, Inc., a Berkshire Hathaway Company. All Rights Reserved. 08/01 Palomino

¹ Estimated Average based on standard build optional equipment